

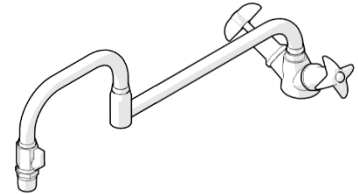

Ezy-Wash CP-BS Lead Safe V/R Hob Twin Mixer Pot & Kettle Filler Unit with Folding Outlet & Stop

PRODUCT CODES:

- 181.05.80.00



SPECIFICATIONS

- Vandal-resistant handles
- All units are finished in bright chrome plate.
- Due to typical applications of this product, it has been designed as 0 star rated to allow fast pot filling.
- The identification buttons on the handles are standard and signify hot or cold water only. If water other than hot or cold is used (e.g. pre-mixed) then appropriate identification buttons will need to be purchased to replace those supplied on the standard unit.
- Lead Safe™ brass construction.*

IMPORTANT: All Ezy-Wash taps are tested in accordance with AS 3718 and leave our premises in good working order.

*Our Lead Safe™ product range is compliant with the Lead-Free Requirements of the NCC 2022 Vol. Three, Clause A5G4(2) and NSF/ANSI 372.
**Any flow controller incorporated in the outlet to be tightened to prevent removal by hand. As Per AS 3718.

WARNINGS: Special attentions to be paid on notes, photos, images, or drawings of assembly steps marked with the warning symbol.



TECHNICAL DATA

Inlet	G 1/2" - Female	
Outlet	Aerator	
Headwork	Ceramic Disc	
Working Pressure Range (kPa)	Min	50
	Max	500
Working Temperature Range (°C)	Min	5
	Max	65
Finish	Chrome	

NOTE: Galvin Engineering continually strive to improve their products. Specifications may change without notice.

TOOLS REQUIRED

- Power drill
- Spanner or adjustable crescent
- Thread tape

PRE-INSTALLATION – MOUNTING DETAILS

- If mounting hole does not already exist, mark out and drill the hole in the bench, as shown. 
- This model is a single inlet unit requiring a hole diameter of 31mm – 35mm. Ensure 70mm minimum between wall and hole center as shown "A".
- Maximum bench thickness is 45mm.

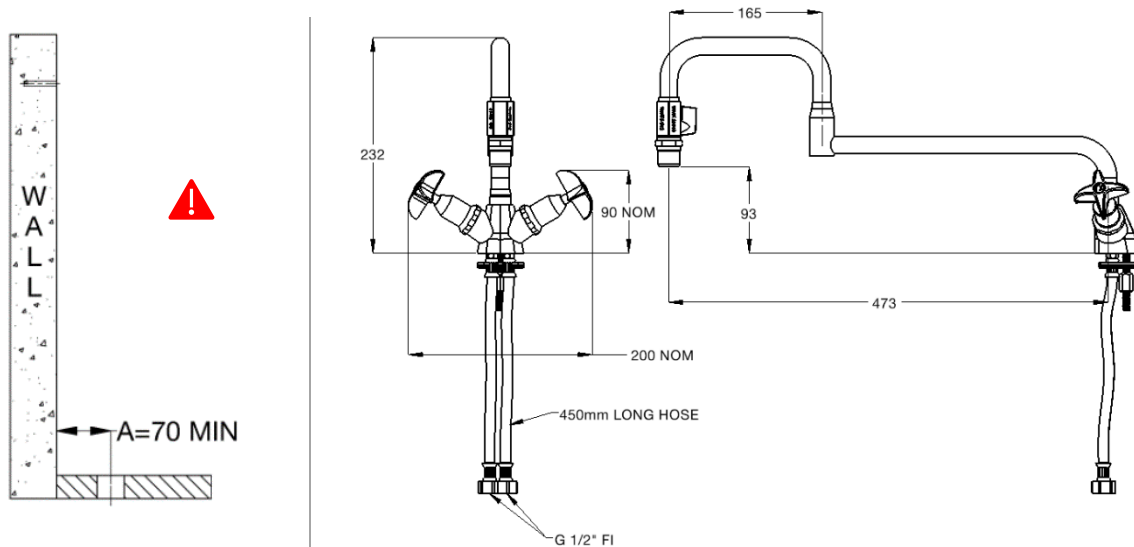

INSTALLATION

IMPORTANT: Galvin Engineering products must be installed in accordance with these installation instructions and in accordance with AS/NZS 3500, the PCA and your local regulatory requirements. Water and electrical supply conditions must also comply to the applicable national and/or state standards. Failing to comply with these provisions shall void the product warranty and may affect the performance of the product.

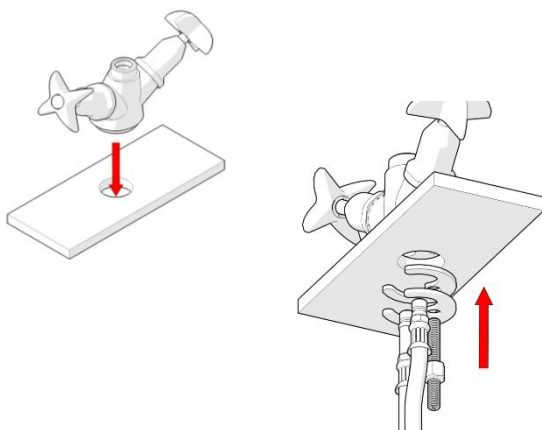

1. Fit tap assembly

- Fit the tap assembly through the drilled hole on the bench.
- Fit the two supplied flexi hoses in to the body
- Secure body with supplied stud nut, ensuring to use rubber and 'C' washer.

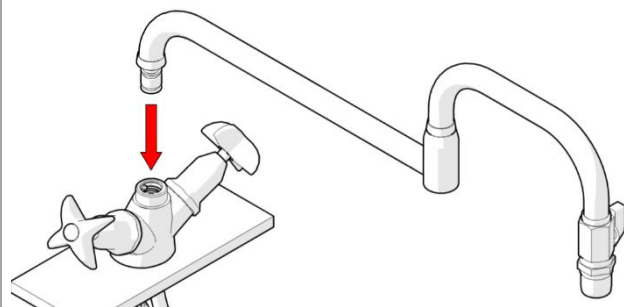

2. Fit outlet & testing

- Remove the protective cap from the pot filler spindle.
- Fit outlet into tap spindle as shown, ensuring both sit flush and taking care not to damage the o-rings.
- Secure outlet with the supplied grub screws.
- Connect mains water supply, turn on the water and test the unit for leaks.

OPERATING INSTRUCTIONS

- The unit must be turned OFF at the base (not at the ball valve) whilst the unit is not in use, to ensure the unit is not under mains pressure when unsupervised. Flood damage may occur if a failure occurs whilst the unit is under mains pressure (warranty is void in this instance).
- Galvin Engineering recommends that a qualified plumber periodically services the unit and the swivel joints are regularly inspected to ensure grub screws remain secure.

TROUBLESHOOTING

PROBLEM	CAUSE	RECTIFICATION
Inconsistent flow	Blocked top assembly	Remove top assembly and clean
Water is not flowing from the tap	Water is turned off	Turn on the water
Continuous flow	Top assembly loose or internally obstructed or damaged	Remove top assembly, clean with water and replace ceramic disc if required
Handle is loose	Screw has come loose	Tighten handle screw

SERVICE AND MAINTENANCE

1. Turn off the water supply and turn on the tap handle to drain water from the bodies.
2. Remove the temperature indicator from the handle.
3. Remove the handle from the tap.
4. Unscrew the ceramic head part from the body.
5. Check the o-ring on the ceramic head part for wear and damage. Replace if required.
6. Clean the head part and the body of any debris.
7. Replace the cartridge and hand tighten back into the body.
8. Follow the product installation guidelines for the relevant product re-assembly method.

WARRANTY

Galvin Engineering products are covered under our Manufacturer's Warranty. Galvin Engineering products must be installed in accordance with the installation instructions and in accordance with AS 3500 and NCC Volume Three, relevant Australian Standards and local authorities applicable to product being installed. Water and electrical supply conditions must also comply to the applicable national and/or state standards, failing to comply with these provisions may void the product warranty and affect performance of the product.

Please visit www.galvinengineering.com.au to view the full warranty, our Installation Compliance and Maintenance & Cleaning information as well as any other additional information.

DEFINITIONS AND DISCLAIMER

Galvin Engineering manufactures a range of products marked as Ligature Resistant or Vandal Resistant. Please visit www.galvinengineering.com.au to read the definition of these terms and the disclaimer that applies to these products.